

Jumper Cables



TECHNICAL DATA

- The flat cables used for NICOMATIC flexcable jumpers equipped with CRIMPFLEX® connectors, are made of two flat copper conductor laminated between two layers of polyester / adhesive insulation.

DIMENSIONS

- Bare copper conductors, section 1.57mm (width) x 0.076mm (thickness).
- Pitch : 2.54 mm.
- Number of conductors : 2 to 36*.
- Insulators thickness : 0.1 mm.

* Higher number of conductors are available by special request



ELECTRICAL SPECIFICATIONS

- Operating voltage 300 V RMS
- Withstand voltage 1100 V RMS
- AC current rating per conductor 3 A
- Resistance 160 Ω /Km

CERTIFICATES

- UL E 235596 / UL E 232912 / UL E 203388
(Appliance Wiring Material - Component)

THERMAL SPECIFICATIONS

- CABLE - 55° C to + 105° C
- UL Flame rating VW-1

MECHANICAL SPECIFICATIONS

- Flex life 0 = once
25 mm = 10 million cycles

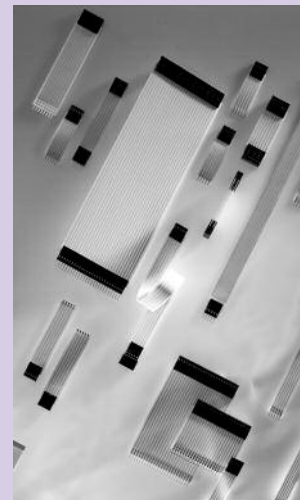

JUMPER CABLE CODES FOR PART NUMBERING SYSTEM ON PAGE 31

CONTACTS TABLE				HOUSINGS TABLE			
CODE	PART NUMBER	CODE	PART NUMBER	CODE	PART NUMBER	CODE	PART NUMBER
F1	I0025-12	M4	I2410-32	V	IL xx	D	OD xx
F2	I0025-32	S1	I0241-12	H	OF xx	2	2E xx
F3	I1506-12	S2	I0141-12			7	7F10 xx
F4	I1506-32	S3	I0167-12	N	OM xx	I	IE xx
F5	I4106-12	S4	I0067-12				
F6	I4106-32	S5	I2887-12	L	OL xx	OTHERS ALSO POSSIBLE	
M1	I3595-12	S6	I1612-12	P	OP xx		
M3	I2410-12	OTHERS ALSO POSSIBLE					

For Flex to discrete wire connection, please consult us.

Jumper Cables

Part Numbering System Using the CRIMPFLEX® Connector System

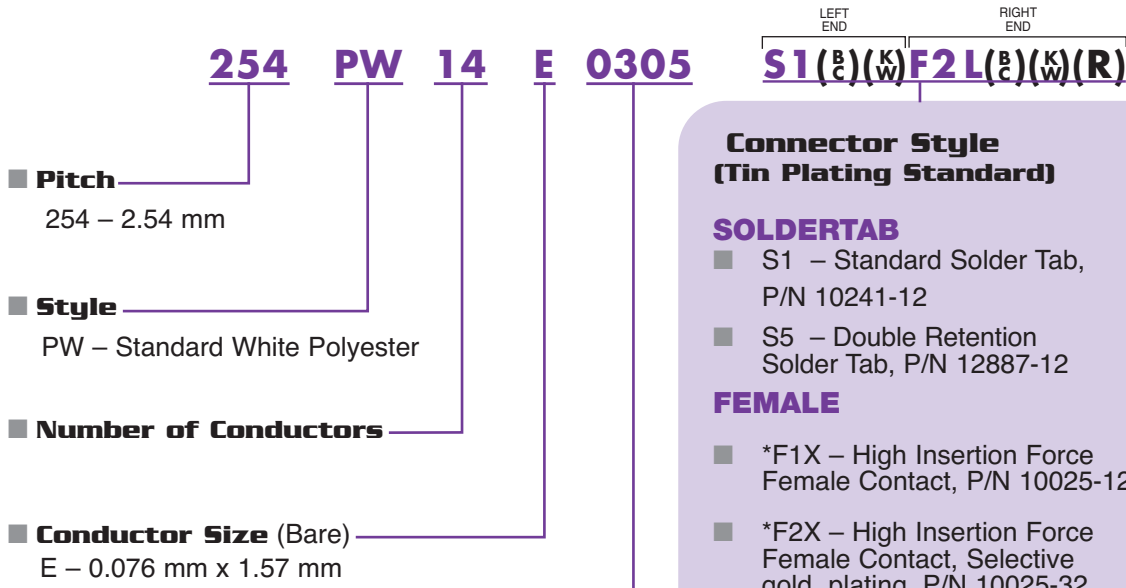

■ **Length in mm**
(Measured from End to End)

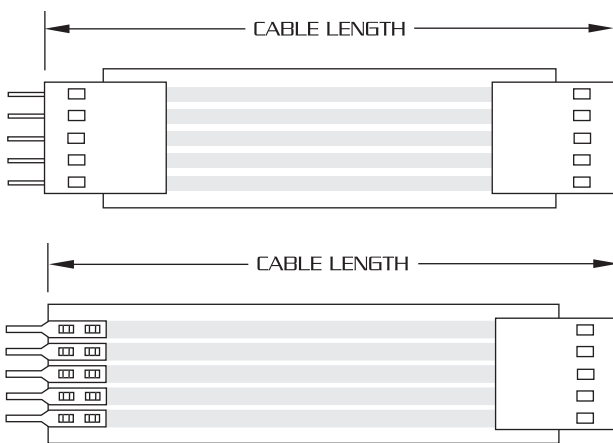

Connector Style (Tin Plating Standard)

SOLDERTAB

- S1 – Standard Solder Tab, P/N 10241-12
- S5 – Double Retention Solder Tab, P/N 12887-12

FEMALE

- *F1X – High Insertion Force Female Contact, P/N 10025-12
- *F2X – High Insertion Force Female Contact, Selective gold plating, P/N 10025-32
- *F3X – Low Insertion Force Female Contact, P/N 11506-12
- *F5X – Hi Flex Female Contact, P/N 14106-12

MALE PIN

- *M1 – Short Square Male Pin, P/N 13595-12
- *M3X – Long Square Male Pin, P/N 12410-12
- *M4X – Long Square Male Pin, Selective gold plating, P/N 12410-32

***housing style must be specified, see below**



B : Bending to the crimping direction



C : Bending to the opposite side

Options : B (-90° bending), C (+90° bending), K (polyimide insulator), R (crimping on the opposite side to the left), W (polyester insulator)

HOUSING - X

■ H – Standard Housing, P/N OF-XX

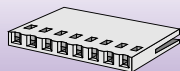

■ L – Latching Housing, P/N OL-XX

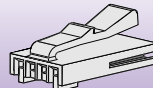

■ 4 – Dual Row Housing, P/N 4F-XX

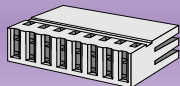

■ D – Detent Style Housing, P/N OD-XX



■ 7 – Low Profile Housing, P/N 7F10-XX

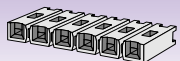

■ V – Latching Receptacle Housing, P/N 1L-XX

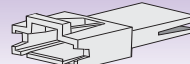

— Other Options are Available, Please Contact the Factory or see page 30 —